

# Stud (tap end 1 x d)

Steel 5.8 - 8.8 - 10.9

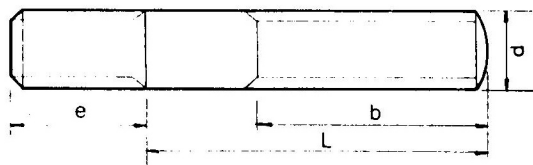

DIN 938

**Designation :**

stud, length of engagement e equal to d, Ø 10 mm normal metric thread and 60 mm non-engaged length L (so 70 mm total length) = DIN 427 M5 x 60.

e	M4	M6	M8	M10	M12	M16	M20	M24	M30		
e	4	5	6	8	10	12	16	20	24	30	
b	x	14	16	18	22	26	30	38	46	54	66
	y	20	22	24	28	32	36	44	52	60	72
L mm	<b>Weights in kg per 1000 pieces</b>										
20	1,90										
25	2,40	3,86	5,50								
30	2,90	4,63	6,60	12,2							
35	3,40	5,30	7,70	14,2	22,7						
40	3,90	5,97	8,80	16,2	25,8	38					
45		6,74	9,90	18,2	28,9	42,4					
50		7,31	11	20,2	32	46,8	89				
60			13,2	24,2	38,2	55,6	105	170			
70				28,2	44,4	64,4	121	194	290		
80				32,2	50,6	73,2	137	218	326	535	
90					56,8	82	153	242	362	591	
100					63	90,8	169	266	398	647	
120						109	201	315	470	757	
140							233	364	542	867	
160							265	413	614	977	
180								463	686	1080	
200									512	758	1190
<b>Packaging</b>	<b>100</b>			<b>50</b>			<b>25</b>				

**Execution :**

A (formerly m) as per DIN 267/2

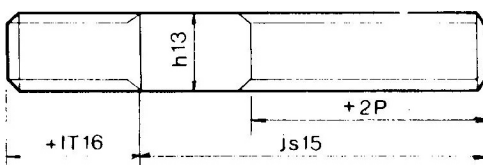

**Thread :**

according to DIN 13 - tolerance class 6 g.